

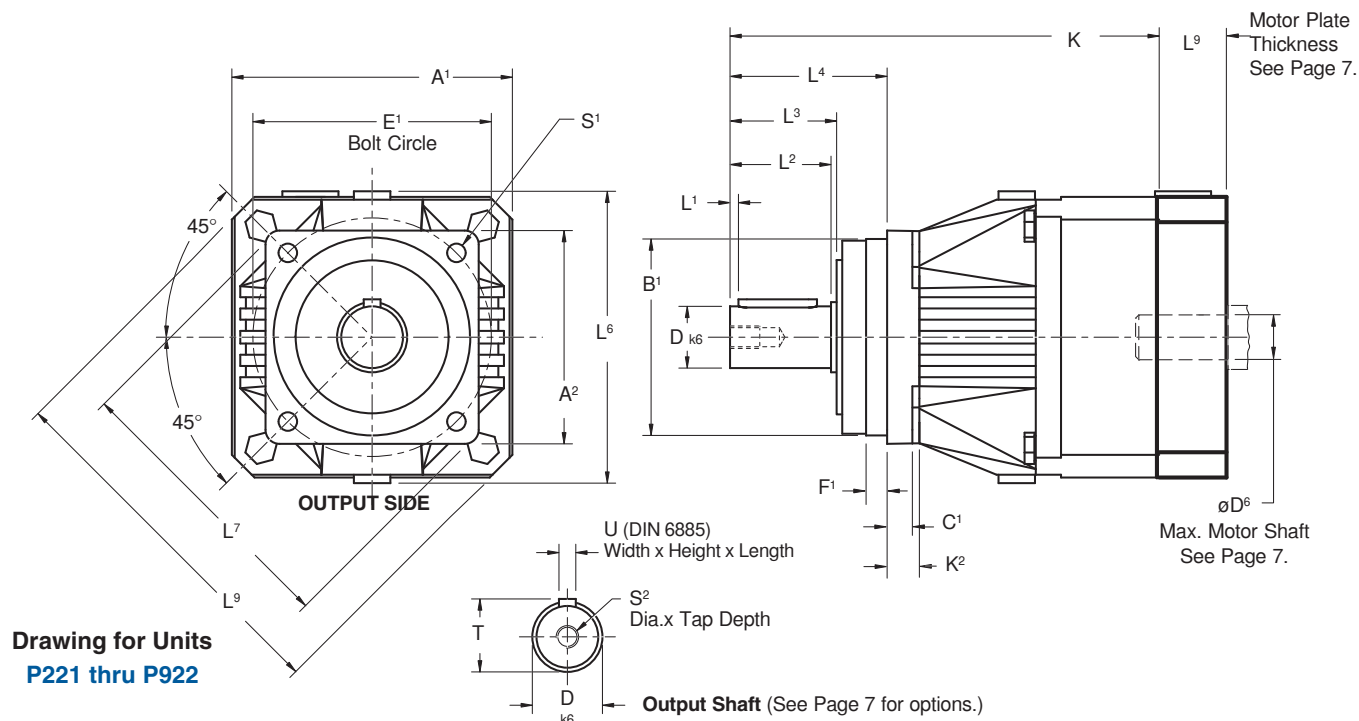

# "P" Series ServoFit® Precision Planetary Gearhead Dimensional Data

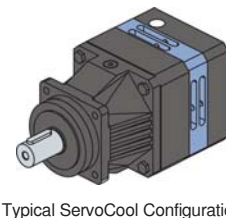
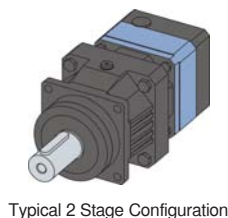

**Table No. 1 "P" Series – Precision Planetary Gearhead Dimensions (mm)**

Unit	A <sup>1</sup>	A <sup>2</sup>	B <sup>1</sup>	h <sub>6</sub>	C <sup>1</sup>	D <sub>k6</sub>	E <sup>1</sup>	F <sup>1</sup>	K <sup>2</sup>	L <sup>1</sup>	L <sup>2</sup>	L <sup>3</sup>	L <sup>4</sup>	L <sup>6</sup>	L <sup>7</sup>	L <sup>8</sup>	S <sup>1</sup>	S <sup>2</sup>	T	U
<b>P221/P222</b>	55	55	50	+0.00/-0.019	6	12 +0.012/+0.001	63	7	—	2	22	24	36	62	74	80	5.5	M4x10	13.5	A4x4x18
<b>P321/P322</b>	72	72	60	+0.00/-0.019	7	16 +0.012/+0.001	75	7.5	—	2	28	30	48	79	92	92	5.5	M5x12.5	18	A5x5x22
<b>P421/P422</b>	98	76	70	+0.00/-0.019	9	22 +0.015/+0.002	85	7.5	12	3	36	38	56	98	103.3	130	6.6	M8x19	24.5	A6x6x28
<b>P521/P522</b>	115	101	90	+0.00/-0.022	10	32 +0.018/+0.002	120	15	14	3	58	60	88	121	139	149	9	M12x28	35	A10x8x50
<b>P721/P722</b>	145	145	130	+0.00/-0.025	15	40 +0.018/+0.002	165	3.5	—	4	82	85	112	145	—	190	11	M16x36	43	A12x8x70
<b>P821/P822</b>	190	190	160	+0.00/-0.025	15	55 +0.021/+0.002	215	10	—	6	82	85	112	190	—	250	13.5	M20x42	59	A16x10x70
<b>P921/P922</b>	225	212	180	+0.00/-0.025	17	75 +0.021/+0.002	250	10	22	7	105	109	143	225	285	300	17.5	M20x42	79.5	A20x12x90

**Table No. 2**

	K Dimension (mm)		
	Standard	ServoCool	
<b>P221</b>	94.5	—	—
<b>P222</b>	126.5	—	—
<b>P321</b>	135	—	—
<b>P322</b>	158.5	—	—
<b>P421</b>	153	<b>P421_C</b>	176.5
<b>P422</b>	200.5	—	—
<b>P521</b>	193	<b>P521_C</b>	221
<b>P522</b>	242.5	<b>P522_C</b>	266
<b>P721</b>	242	<b>P721_C</b>	272
<b>P722</b>	294	<b>P722_C</b>	322
<b>P821</b>	283	<b>P821_C</b>	331
<b>P822</b>	350.5	<b>P822_C</b>	380.5
<b>P921</b>	353	<b>P921_C</b>	418
<b>P922</b>	441	<b>P922_C</b>	489



**Part No. Example**  
**P421SPR0030MTC**



# "P" Series – Large Input ServoFit® Precision Planetary Gearhead Dimensional Data



P

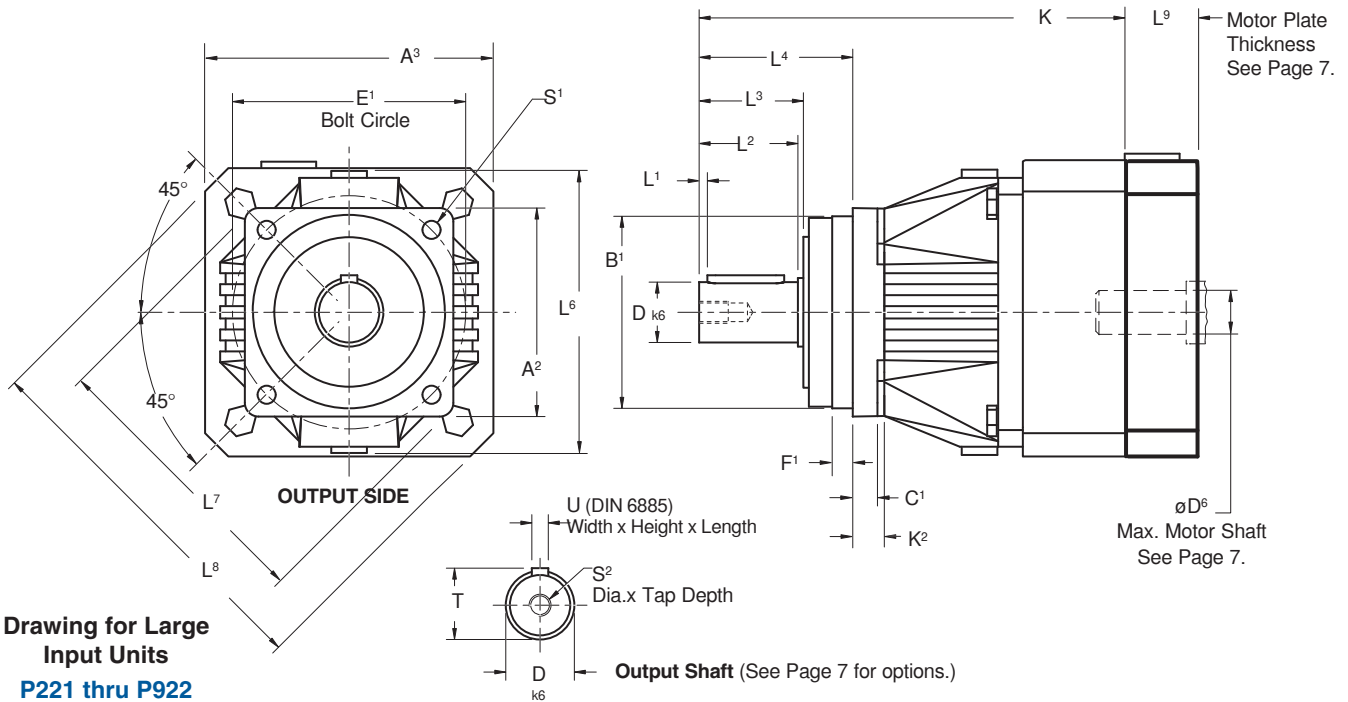

Drawing for Large Input Units  
P221 thru P922

Table No. 1 "P" Series – Large Input – Precision Planetary Gearhead Dimensions (mm)

Unit	A²	B¹ h6	C¹	D k6	E¹	F¹	K²	L¹	L²	L³	L⁴	L⁶	L⁷	S¹	S²	T	U
P221/P222_L	55	50 +.000/-0.019	6	12 +.012/+0.001	63	7	—	2	22	24	36	92	74	5.5	M4x10	13.5	A4x4x18
P321/P322_L	72	60 +.000/-0.019	7	16 +.012/+0.001	75	7.5	—	2	28	30	48	130	92	5.5	M5x12.5	18	A5x5x22
P421/P422_L	76	70 +.000/-0.019	9	22 +.015/+0.002	85	7.5	12	3	36	38	56	149	103.3	6.6	M8x19	24.5	A6x6x28
P521/P522_L	101	90 +.000/-0.022	10	32 +.018/+0.002	120	15	14	3	58	60	88	190	139	9	M12x28	35	A10x8x50
P721/P722_L	145	130 +.000/-0.025	15	40 +.018/+0.002	165	3.5	—	4	82	85	112	250	—	11	M16x36	43	A12x8x70
P821/P822_L	190	160 +.000/-0.025	15	55 +.021/+0.002	215	10	—	6	82	85	112	190	—	13.5	M20x42	59	A16x10x70
P922_L	212	180 +.000/-0.025	17	75 +.021/+0.002	250	10	22	7	105	109	143	225	285	17.5	M20x42	79.5	A20x12x90



Typical 2 Stage Configuration  
Large Input

Part No. Example  
P421SPR0030MTL

Table No. 2

Unit	A³	K	L⁸
P221_L	75	111	100
P222_L	75	143	100
P321_L	100	138.3	130
P322_L	75	175	100
P421_L	115	161.5	149
P422_L	100	203.8	130
P521_L	145	207	190
P522_L	115	251	149
P721_L	190	259	250
P722_L	145	308	190
P821_L	225	291	300
P822_L	190	367.5	250
P922_L	225	449	300

See Page 6 for Options and Part Number Configuration.