



"C" Series – MGS® Adjustable Speed Drives Dimensional Data



Drawing for Units
C002N — C503N

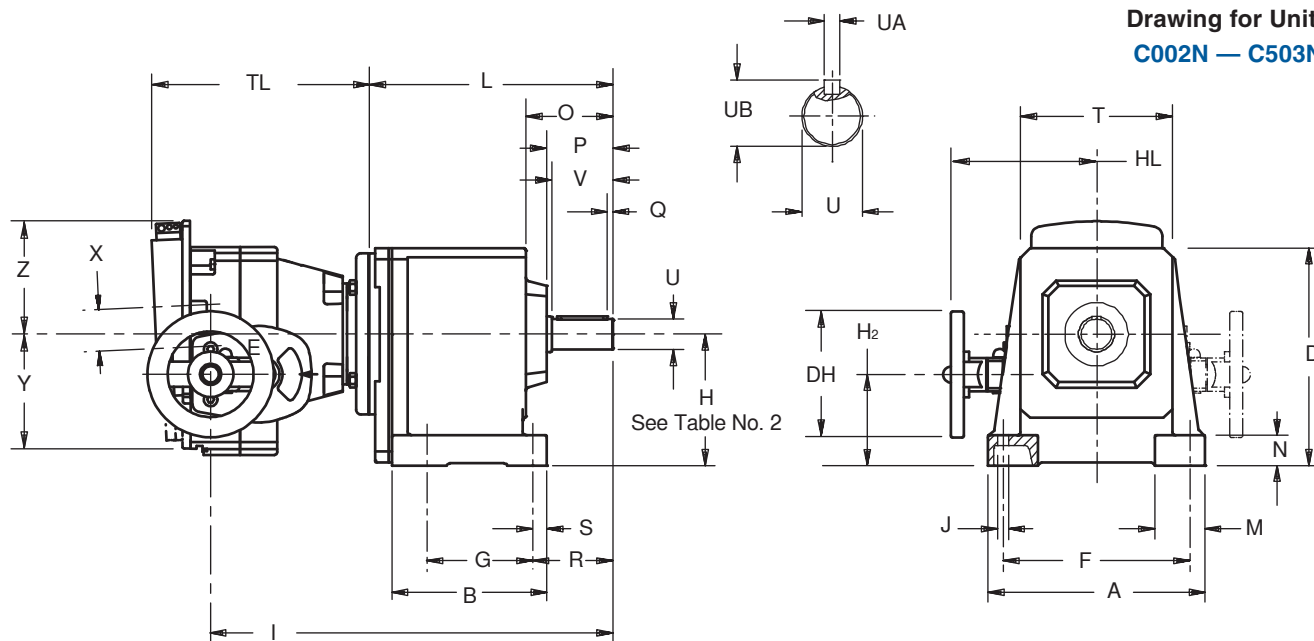

Table No. 1 "C" Series with ComTrac – Foot Mounting Unit Dimensions (Inches) – "N" Housing Style

Base Module	A	B	D	F	G	H	J	M	N	O	P	Q	R	S	T	V	Z ₁
C002	5.20	3.74	5.67	4.33	2.44	3.23	.28	1.38	.79	2.24	1.73	.16	2.17	.43	3.62	1.57	—
C102/C103	6.93	4.65	6.97	5.91	2.76	4.02	.35	1.65	.98	2.72	2.13	.16	2.64	.51	4.88	1.97	—
C202/C203	7.87	5.31	7.68	6.69	3.35	4.53 ¹⁾	.43	1.97	1.18	3.39	2.56	.16	3.11	.55	5.43	2.36	—
C302/C303	8.46	6.06	8.46	7.28	4.13	5.12 ¹⁾	.43	1.97	1.18	3.35	2.56	.16	3.11	.55	5.91	2.36	—
C402/C403	10.04	7.09	9.65	8.66	4.33	5.71	.55	2.36	1.38	4.17	3.39	.16	4.13	.75	6.89	3.15	—
C502/C503	11.42	7.76	11.42	9.65	5.12	6.69	.71	2.76	1.57	4.21	3.39	.16	4.25	.87	7.56	3.15	—
C612/C613	11.81	10.43	12.40	9.65	8.46	7.87 ¹⁾	.71	2.95	1.57	6.02	4.17	.20	5.12	.98	6.97	3.94	6.57
C712/C713	14.37	11.22	14.76	11.81	9.25	9.25 ¹⁾	.71	3.54	1.97	7.28	5.00	.20	6.42	.98	7.56	4.72	7.91
C812/C813	17.13	14.17	17.72	13.39	11.81	11.42	.87	3.74	2.17	8.58	5.83	.39	7.48	1.14	8.78	5.51	8.70
C912/C913	20.08	16.14	20.87	15.75	13.39	13.39	1.02	4.33	2.36	10.08	7.01	.39	8.74	1.34	10.91	6.69	10.24

¹⁾ See Table No. 2. These sizes are not coaxial. H=Output Height, H₁=Input Height.

Table No. 2 H₁ Dimension (Inches)

Base Module	TD27	TD37	TD47	TD57	TD67	TD76
C203	3.07	—	—	—	—	—
C303	3.66	3.66	—	—	—	—
C612	—	—	7.64	7.64	7.64	7.64
C613	7.64	7.64	7.64	7.64	—	—
C713	—	—	—	—	8.50	—

These sizes are not coaxial.

H=Output Height, H₁=Input Height.

Table No. 3 "C" Series Shaft Dimensions (Inches)

Base Module	U	Tolerance	UA—Key	UB
C002	.7500	+0.000/-0.0006	3/16 × 3/16 × 17/32	.83
C102/C103	1.0000	+0.000/-0.0006	1/4 × 1/4 × 19/16	1.11
C202/C203	1.2500	+0.000/-0.0007	1/4 × 1/4 × 1 ¹⁵ / ₁₆	1.36
C302/C303	1.2500	+0.000/-0.0007	1/4 × 1/4 × 1 ¹⁵ / ₁₆	1.36
C402/C403	1.6250	+0.000/-0.0007	3/8 × 3/8 × 2 ⁷ / ₈	1.79
C502/C503	1.6250	+0.000/-0.0007	3/8 × 3/8 × 2 ⁷ / ₈	1.79
C612/C613	2.1250	+0.000/-0.0008	1/2 × 1/2 × 3 ⁵ / ₃₂	2.35
C712/C713	2.3750	+0.000/-0.0008	5/8 × 5/8 × 3 ¹⁵ / ₁₆	2.65
C812/C813	2.8750	+0.000/-0.0008	3/4 × 3/4 × 4 ⁵ / ₁₆	3.21
C912/C913	3.6250	+0.000/-0.0009	7/8 × 7/8 × 5 ¹ / ₂	4.01

Table No. 4

"C" Series with ComTrac Dimensions (Inches)

ComTrac Part No.	NEMA C-Flange	DH	HL	TL	X	Y	Z
TD270K050	56C	4.92	5.67	7.87	2.09	5.55	4.41
TD270K140	143/145TC	4.92	5.67	7.87	2.09	5.55	4.41
TD370K140	143/145TC	4.92	5.91	8.50	2.17	5.67	4.37
TD470K180	182/184TC	6.30	6.81	8.94	2.80	7.20	5.59
TD570K180	182/184TC	7.87	8.31	11.89	3.11	8.11	6.30
TD670K210	213/215TC	7.87	9.17	12.17	3.86	9.02	7.13
TD760K210	213/215TC	9.84	9.72	14.25	4.29	9.37	7.68



"C" Series – MGS® Adjustable Speed Drives Dimensional Data



Drawing for Units
C612N — C913N

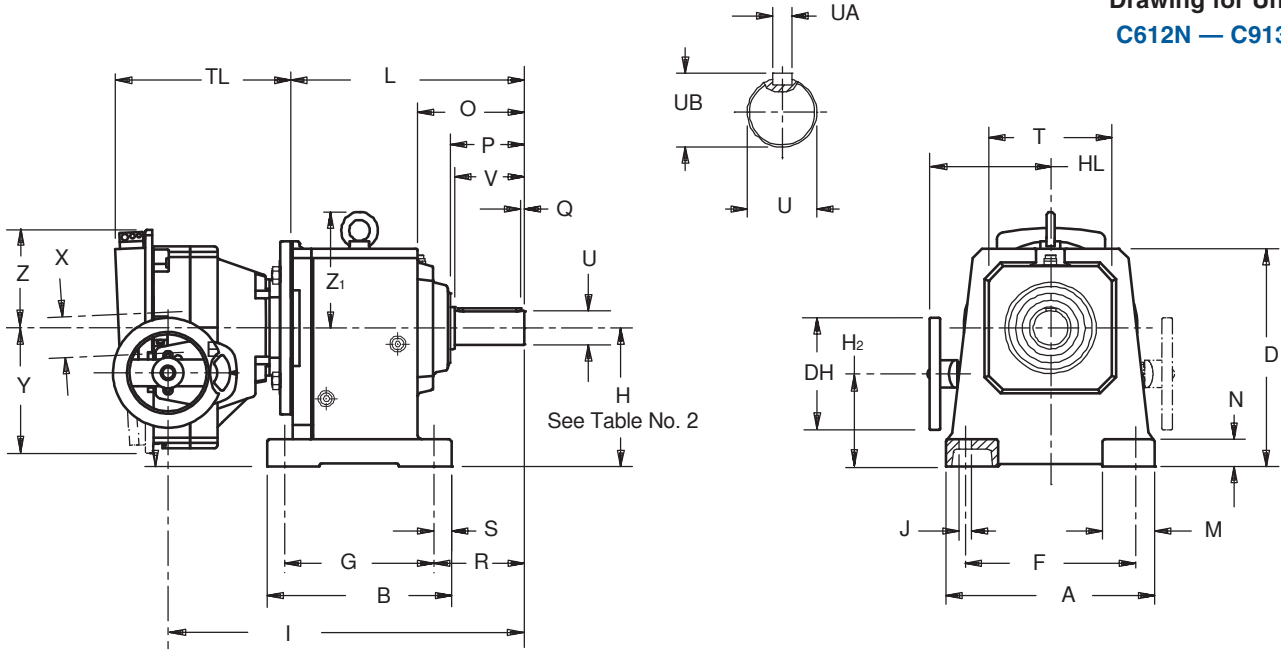

Table No. 5 "C" Series with ComTrac – Foot Mounting Unit Dimensions (Inches) – "N" Housing Style

Base	TD270K050 ⁽²⁾			TD370K140			TD470K180			TD570K180			TD670K210			TD760K210		
	H ₂	I	L	H ₂	I	L	H ₂	I	L	H ₂	I	L	H ₂	I	L	H ₂	I	L
C002	1.65	12.40	6.22	1.18	13.07	6.22	—	—	—	—	—	—	—	—	—	—	—	—
C102	2.44	13.70	7.52	1.97	14.37	7.52	1.42	14.49	7.60	—	—	—	—	—	—	—	—	—
C202	2.95	14.80	8.62	2.48	15.47	8.62	1.93	15.59	8.70	1.18	18.23	8.70	—	—	—	—	—	—
C203⁽¹⁾	1.50	16.50	10.31	—	—	—	—	—	—	—	—	—	—	—	—	—	—	—
C302	3.54	15.55	9.37	3.07	16.22	9.37	2.52	16.34	9.45	1.77	18.98	9.45	1.57	19.29	9.57	—	—	—
C303⁽¹⁾	2.09	17.24	11.06	1.61	17.91	11.06	—	—	—	—	—	—	—	—	—	—	—	—
C402	4.13	17.44	11.24	3.66	18.11	11.26	3.11	18.23	11.34	2.36	20.87	11.34	2.17	21.18	11.46	—	—	—
C403	4.13	19.13	12.95	3.66	19.80	12.95	—	—	—	—	—	—	—	—	—	—	—	—
C502	—	—	—	4.65	18.94	12.09	4.09	19.06	12.17	3.35	21.69	12.17	3.15	22.01	12.28	3.15	24.45	12.83
C503	5.12	19.96	13.78	4.65	20.63	13.78	—	—	—	—	—	—	—	—	—	—	—	—
C612⁽¹⁾	—	—	—	—	—	—	5.04	20.00	13.11	4.29	22.64	13.11	4.09	22.95	13.23	4.09	25.35	13.74
C613⁽¹⁾	6.06	20.94	14.76	5.59	21.61	14.76	5.04	22.44	15.55	4.29	25.08	15.55	—	—	—	—	—	—
C712	—	—	—	—	—	—	6.65	22.09	15.20	5.91	24.72	15.20	5.71	25.00	15.28	5.71	27.40	15.79
C713⁽¹⁾	—	—	—	—	—	—	6.65	24.49	17.60	5.91	27.13	17.60	6.46	27.80	18.07	—	—	—
C812	—	—	—	—	—	—	—	—	—	—	—	—	7.87	27.64	17.91	7.87	29.65	18.03
C813	—	—	—	—	—	—	8.82	27.13	20.24	8.07	29.76	20.24	7.87	30.43	20.71	—	—	—
C912	—	—	—	—	—	—	—	—	—	—	—	—	—	—	—	9.84	32.68	21.06
C913	—	—	—	—	—	—	—	—	—	—	—	—	9.84	32.28	22.56	9.84	35.94	24.33

⁽¹⁾ See Table No. 2. These sizes are not coaxial. H=Output Height, H₁=Input Height.

⁽²⁾ Also **TD270FK140** for a NEMA 143TC frame motor.

Table No. 6 "C" Series with ComTrac – Approximate Weight (lbs.)

Part Number	C002	C102	C202	C203	C302	C303	C402	C403	C502	C503	C612	C613	C712	C713	C812	C813	C912	C913
TD270K050⁽²⁾	51	62	71	78	82	89	104	111	128	144	—	148	—	—	—	—	—	—
TD370K140	69	80	89	—	100	107	122	129	146	162	—	210	—	—	—	—	—	—
TD470K180	—	88	97	—	108	—	130	—	154	—	174	218	258	280	—	401	—	—
TD570K180	—	—	126	—	137	—	159	—	183	—	203	247	287	309	—	430	—	—
TD670K210	—	—	—	—	179	—	201	—	225	—	245	—	329	351	452	472	—	808
TD760K210	—	—	—	—	—	—	—	—	289	—	309	—	393	—	516	—	790	872

⁽²⁾ Also **TD270FK140** for a NEMA 143TC frame motor.

Part No. Example

Foot Mounting with ComTrac, 56C Input, .75 HP motor
C302N0620 TD270K050-075